

CFX-I AUTOMATIC LIFEJACKET LIGHT INSTALLATION INSTRUCTIONS



Figure 1

It is very important that the CFX be secured properly to the lifejacket. Correct attachment of the lifejacket light to the lifejacket will ensure that the light is securely attached, leaving water sensors open for initial exposure to the water and the switch free to move up and down. Follow the instructions for the lifejacket manufacturer for the correct attachment of the lifejacket light to the jacket.

We recommend mounting the CFX-I on the lifejacket as follows:

1. Attach the CFX battery firmly to a strap using the plastic clip bracket provided with the CFX (see figure 1). Feed the strap along the back of the CFX and fasten the bracket to the battery by pushing the clip's plastic hooks through the corresponding holes on the battery housing. The plastic spikes should face inwards (see figure 2), holding the strap firmly in place.

or

2. Attach the battery firmly to a strap with tie wraps.

Figure 2

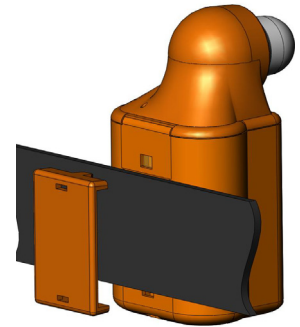

Please note:

1. The CFX should fit snugly to the strap or the lifejacket, and not dangle without support.
2. At all times make sure that the yellow switch rod is in the upper position "AUTO", (if not move it up to "AUTO") so that the CFX will be ready for automatic activation following immersion in water.
3. It is always best to follow the instructions of the lifejacket manufacturer for the correct attachment of the lifejacket light to the jacket. If you encounter any uncertainty on how to attach the CFX to the lifejacket please contact the lifejacket manufacturer or Electric Fuel at safety@electric-fuel.com. Only a secure attachment will ensure that the light remains attached to the vest at all times.

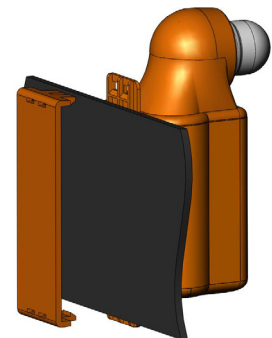

Electric Fuel will not assume any responsibility for lights improperly affixed, and improper affixing of the light will void all warranties.